

# **JAVES**

## **Multi-Media DLP projector**

### **OLX-730 / OLX-625**



## **User Manual**



## **Declaration of Conformity**

We declare under our sole responsibility that this projector conform to the following directives and norms:

EMC Directive 89/336/EEC, Amended by 93/68/EEC

EMC: EN 55022

EN 55024

EN 61000-3-2

EN 61000-3-3

Low Voltage Directive 73/23/EEC, Amended by 93/68/EEC

Safety: IEC 60950-1

## **Trademarks**

Apple, Macintosh, and PowerBook are trademarks or registered trademarks of Apple Computer, Inc. IBM is a trademark or registered trademark of International Business Machines, Inc. Microsoft, PowerPoint, and Windows are trademarks or registered trademarks of Microsoft Corporation. Adobe and Acrobat are trademarks or registered trademarks of Adobe Systems Incorporated.

## **FCC Warning**

This equipment has been tested and found to comply with the limits for a Class A digital device, pursuant to part 15 of the FCC Rules. These limits are designed to provide reasonable protection against harmful interference when the equipment is operated in a commercial environment. This equipment generates, uses, and can radiate radio frequency energy and, if not installed and used in accordance with the instruction manual, may cause harmful interference to radio communications. Operation of this equipment in a residential area is likely to cause harmful interference in which case the user will be required to correct the interference at his own expense.

## **EN 55022 Warning**

This is a Class A product. In a domestic environment it may cause radio interference, in which case the user may be required to take adequate measures. The typical use is in a conference room, meeting room or auditorium.

## **Canada**

This Class A digital apparatus complies with Canadian ICES-003.

Cet appareil numérique de la classe A est conforme à la norme NMB-003 du Canada.

Other specific Country Approvals may apply. Please see product certification label.

This document applies to: Orion High, Orion Low, Gen1000, Gen1010, C165, C185, T195, T190.

# Table of Contents

<b>Introduction</b> .....	5
<b>Connecting a computer</b> .....	7
<b>Displaying a computer image</b> .....	9
Adjusting the image .....	10
<b>Connecting a video device</b> .....	11
Standard video connections .....	11
Optional video connections .....	11
<b>Displaying a video image</b> .....	12
<b>Shutting down the projector</b> .....	14
<b>Troubleshooting your setup</b> .....	14
Source troubleshooting .....	15
Projector troubleshooting .....	17
<b>Using the keypad buttons</b> .....	22
<b>Using the remote control</b> .....	23
<b>Using the menus</b> .....	24
Auto image .....	25
Aspect ratio .....	25
Personal .....	25
Picture .....	26
Audio .....	27
Language .....	28
Settings .....	28
Service .....	30
Help .....	31
<b>Maintenance</b> .....	32
Cleaning the lens .....	32
Replacing the projection lamp .....	32
Cleaning the dust filter .....	34
Using the security lock .....	34
<b>Appendix</b> .....	35
Accessories .....	35
Blue LED behavior and meaning .....	35
Red LED behavior and projector errors .....	35
Projected image size .....	36
Rs-232 terminal specification .....	37

## Important Operating Considerations for Safety

- Important, Please read the following instruction before attempting to operate the projector.
- Place the projector in a horizontal position no greater than 15 degrees off axis.
- Locate the projector in a well-ventilated area without any obstructions to intake or exhaust vents. Do not place the projector on a tablecloth or other soft covering that may block the vents.
- To reduce the risk of fire or electrical shock, do not expose this appliance to rain or moisture.
- Locate the projector at least 4' (1.2 m) away from any heating or cooling vents.
- Use only approved ceiling mounts.
- Use only the power cord provided. A surge-protected power strip is recommended.
- Refer to this manual for proper startup and shutdown procedures.
- In the unlikely event of the lamp rupturing, discard any edible items placed in the surrounding area and thoroughly clean the area along all sides of the projector. Wash hands after cleaning the area and handling the ruptured lamp. This product has a lamp which contains a very small amount of mercury. Dispose of it as required by local, state or federal ordinances and regulations. For more information see [www.eiae.org](http://www.eiae.org).

Follow these instructions to help ensure image quality and lamp life over the life of the projector. Failure to follow these instructions may affect the warranty.

**NOTE** : Do not place objects or people in the 2 foot (.6m) area along the side of the projector. For ceiling mount applications, this area should be 5 feet (1.5m).

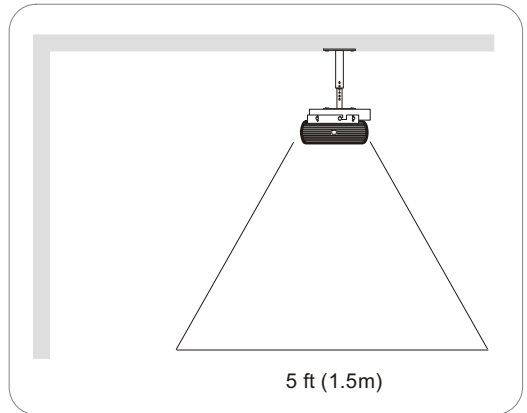
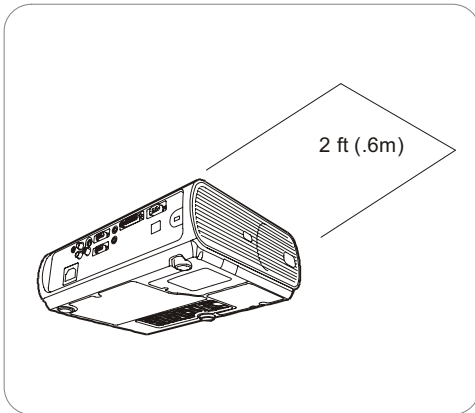

If you are experienced in setting up presentation systems, use the included Quick Set Up card. For complete details on connecting and operating the projector, refer to this User's Guide.

# Introduction

Your new digital projector provides computer and video inputs and has XGA 1024x768 resolution. The projector is easy to connect, easy to use, easy to maintain.

## Included items

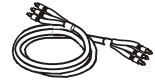
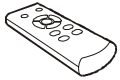
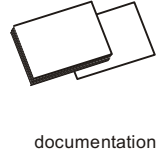
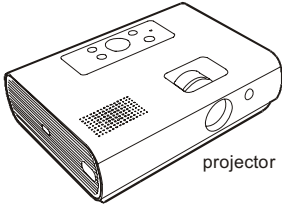

## Projector components and features

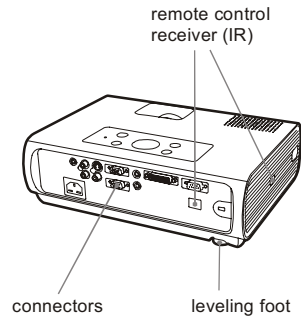
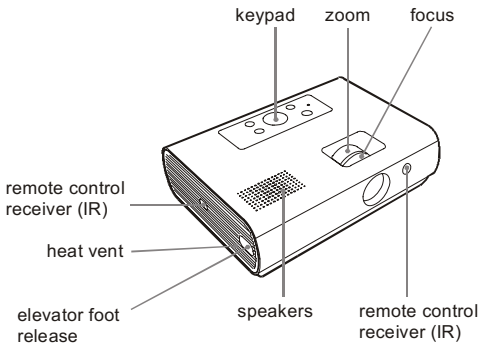

## Connector Panel

The projector provides two computer and two video connectors:

- one M1-D/A (HD, DVI, and computer)
- one VESA computer
- one S-video
- one composite RCA

It also has an RS-232 serial connector for serial control.

## The projector's connector panel

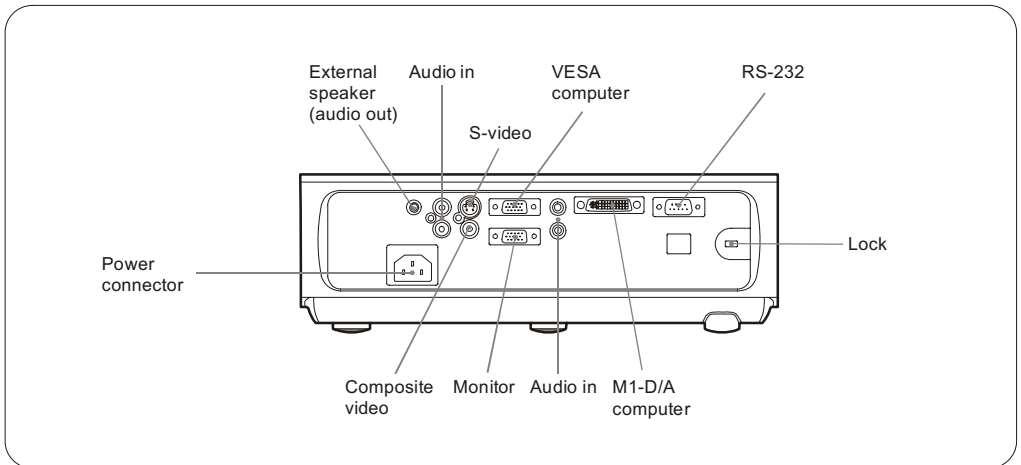

# Connecting a computer

Connect the black end of the computer cable to the **Source 1** connector on the projector. Connect the blue end to the video port on your computer. If you are using a desktop computer, you first need to disconnect the monitor cable from the computer's video port.

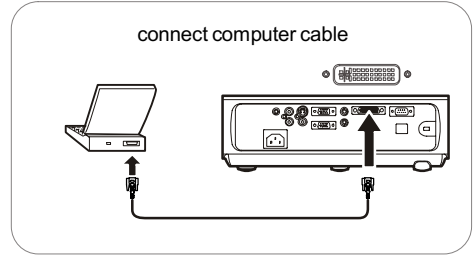

Connect the black power cable to the connector on the back of the projector and to your electrical outlet. The Power LED on the projector's keypad turns solid blue.

**NOTE** : Always use the power cable that is shipped with the projector.

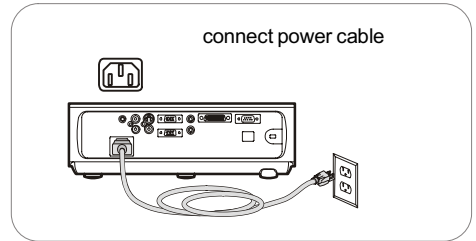

To have sound with your presentation, connect an optional audio cable to your computer and to the computer **Audio In** connector on the projector. An optional audio cable can be purchased in a computer or projector accessories store.

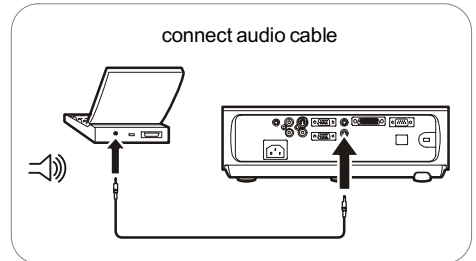

If you are using a desktop computer and want to see the image on your computer screen as well as on the projection screen, plug the monitor cable to the black **Monitor Out** connector on the projector.

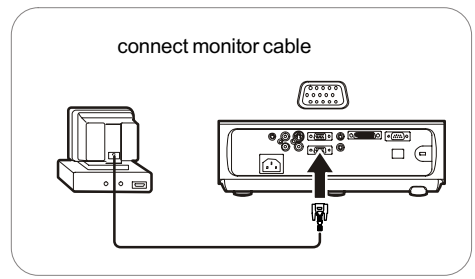

If you prefer connecting your projector to your computer with an optional VESA cable, connect one end of the cable to the VESA port on your computer, and connect the other end of the cable to the blue **Source 2** connector on the projector.

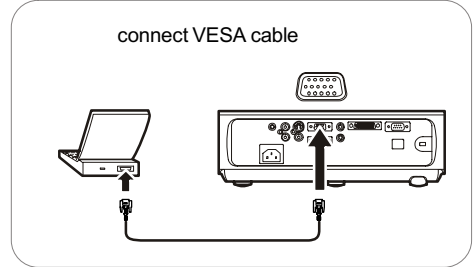

You can control the projector from computer by connecting an RS-232 cable to the projector's **Serial Control** connector.

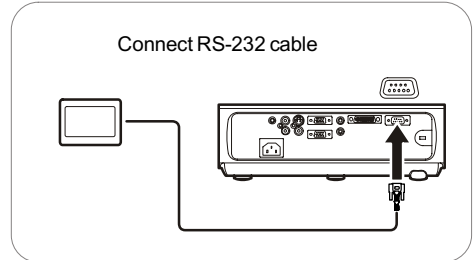

# Displaying a computer image

Press the **Power** button on the top of the projector or the remote. The LED flashes blue and the fans start to run. When the lamp comes on, the startup screen is displayed. It can take about 30 seconds for the image to achieve full brightness.

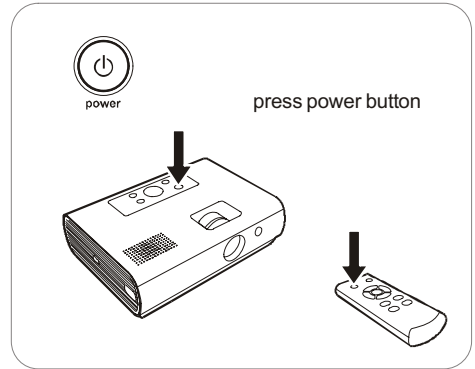

Turn on your computer.

The computer's image should appear on the projection screen. If it doesn't, press the **Source** button on the projector's keypad.

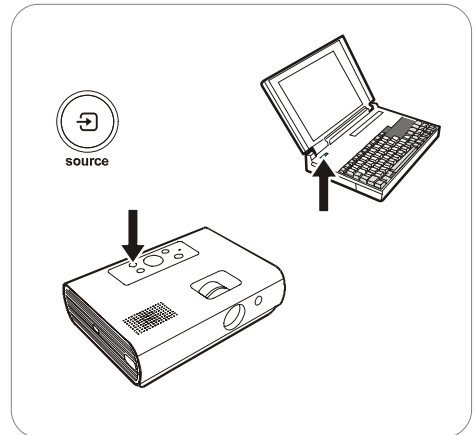

Make sure your laptop's external video port is active.

Many laptops do not automatically turn on their external video port when a projector is connected. Usually a key combination like FN + F5 is used to turn the external display on and off. Refer to your computer's documentation to learn your computer's key combination.

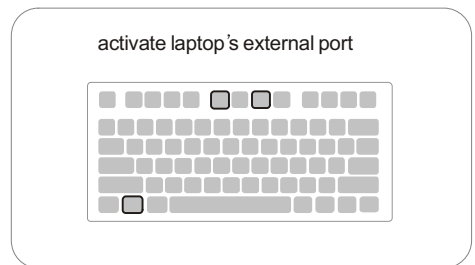

**TIP:** No computer image? Try pressing the **Source** button on the keypad. Get help on page 15.

## Adjusting the image

Adjust the height of the projector, if necessary, by pressing the release button to extend the elevator foot. Rotate the leveling foot (located at the bottom back corner), if necessary.

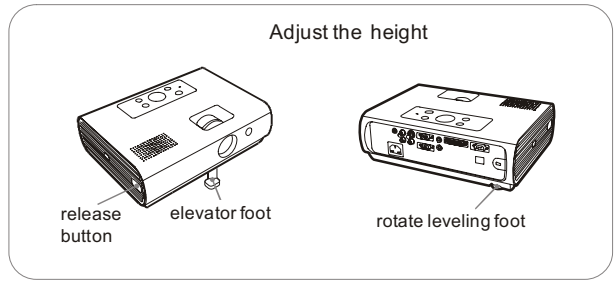

Position the projector the desired distance from the screen at a 90 degree angle to the screen.

See page 36 for a table listing screen sizes and distances.

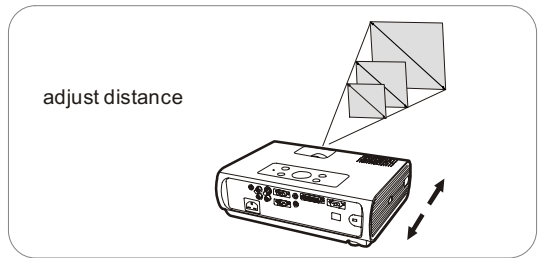

Adjust the zoom or focus rings by rotating them until the desired image size and focus are produced.

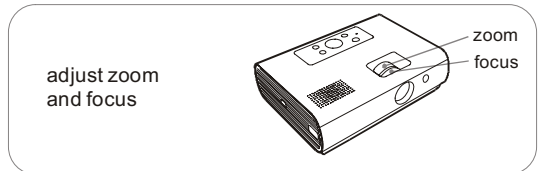

If the image is not square, adjust the vertical digital keystone by using the buttons on the keypad. Press the upper **Keystone** button to reduce the upper part of the image, and press the lower **Keystone** button to reduce the lower part.

See page 29.

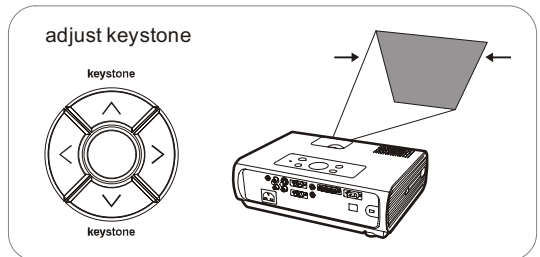

Adjust the Contrast or Brightness in the Picture menu.

See page 26 for help with the menus.

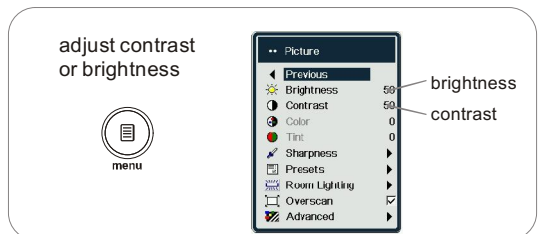

# Connecting a video device

## Standard video connections

Plug the audio/video (A/V) cable's yellow connector into the video-out connector on the video device. Plug the other yellow connector into the yellow **Video** connector on the projector. Plug a white connector into the white audio out connector on the video device and plug a red connector into the red audio out connector on the video device. Plug the remaining white connector into the white **Video Audio in** connector on the projector, and plug the red connector into the red **Video Audio in** connector on the projector.

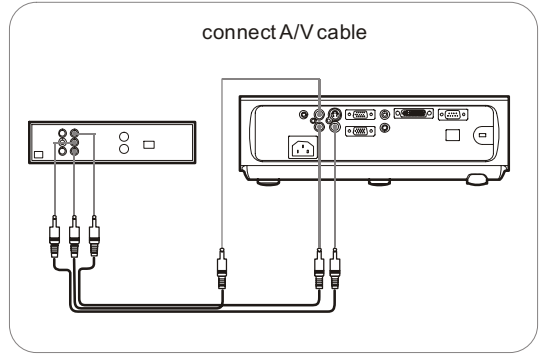

Connect the black power cable to the connector on the back of the projector and to your electrical outlet.

**NOTE:** Always use the power cable that is shipped with the projector.

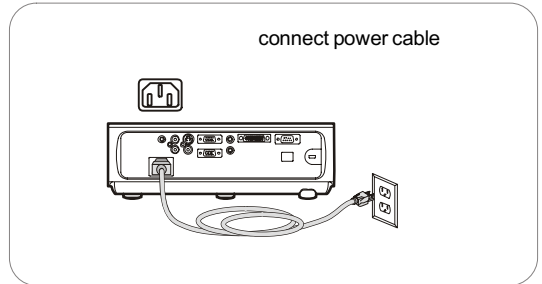

## Optional video connections

If the video device uses a round, four-prong S-video connector, plug an S-video cable (sold separately) into the S-video connector on the video device and into the **S-Video** connector on the projector. Use the A/V cable's audio connectors as described directly above (the yellow connectors on the A/V cable are not used).

To connect a progressive scan EDTV or HD source, use the Component to VESA adapter (sold separately).

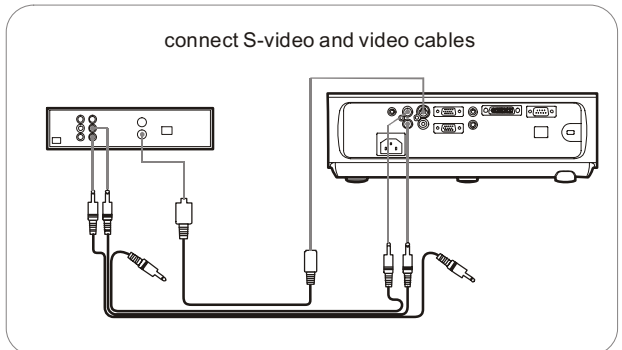

# Displaying a video image

Press the **Power** button on the top of the projector or on the remote. The LED flashes blue and the fans start to run. When the lamp comes on, the startup screen is displayed. It can take about 30 seconds for the image to achieve full brightness.

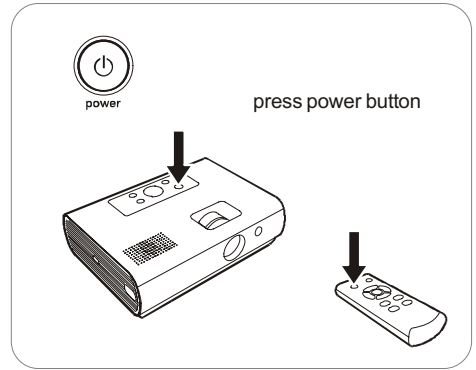

Plug in and turn on the video device.

The video device's image should appear on the projection screen. If it doesn't, press the **Source** button on the keypad.

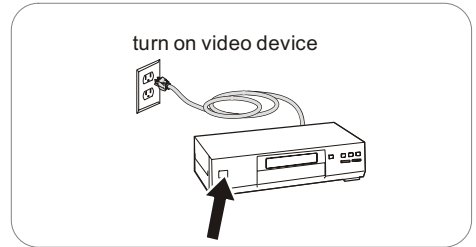

Adjust the height of the projector by pressing the release button to extend the elevator foot. Rotate the leveling foot, if necessary.

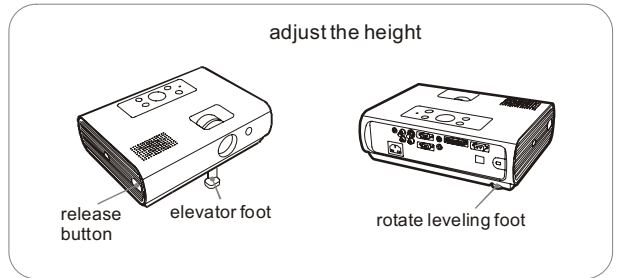

Position the projector the desired distance from the screen at a 90 degree angle to the screen.

See page 36 for a table listing screen sizes and distances.

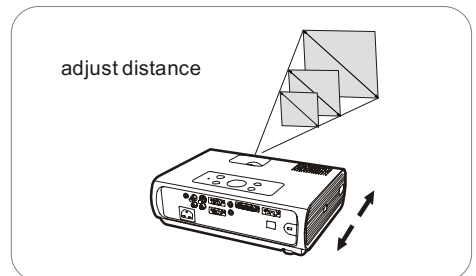

Adjust the zoom or focus rings by rotating them until the desired image size and focus are produced.

adjust zoom  
and focus

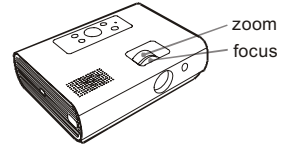

If the image is not square, adjust the keystone by using the buttons on the keypad. Press the upper **Keystone** button to reduce the upper part of the image, and press the lower **Keystone** button to reduce the lower part.

*See page 29.*

adjust keystone

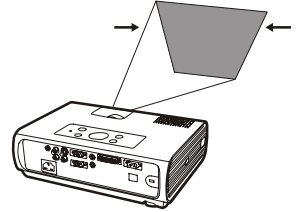

Adjust the volume on the keypad or the remote.

adjust volume

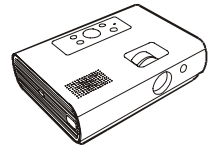
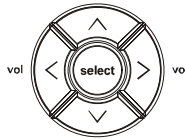

Adjust the **Contrast**, **Brightness**, **Color**, or **Tint** in the Picture menu.

*See page 26 for help with the menus.*

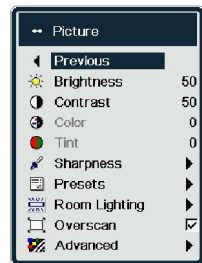

# Shutting down the projector

The projector automatically displays a white screen after no active source is detected for 15 minutes. This white screen helps preserve the life of the projector. The image returns when an active source is detected or a remote or keypad button is pressed.

## Screen Save

You can make the white screen appear after a preset number of minutes by turning on the Screen Save feature in the **Settings** menu. *See page 29.*

## Power Save

The projector also has a **Power Save** feature that automatically turns the lamp off after no active sources are detected and no user interaction with the projector is performed for 20 minutes. By default, this feature is off. *See page 28.*

## Turning off the projector

To turn the projector off, press the **Power** button on the remote or keypad two times (the second time verifies the shut-down request). The lamp turns off and the Power light on the Status Indicator Panel blinks blue for 80 seconds while the fans continue to run to cool the lamp. During the blinking blue, the projector does not accept any keypad and remote control input. When the lamp is fully cooled, the Power light turns solid blue.

# Troubleshooting your setup

If your image appears correctly on the screen, skip to the next section. If it does not, troubleshoot the setup.

## Source Troubleshooting

The following tables show common problems. In some cases, more than one possible solution is provided. Try the solutions in the order they are presented. When the problem is solved, you can skip the additional solutions.

Problem

only startup screen appears

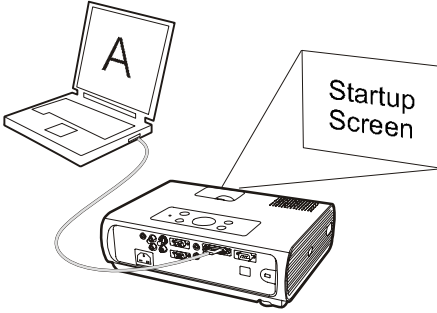

The video embedded in my PowerPoint presentation does not play on the screen

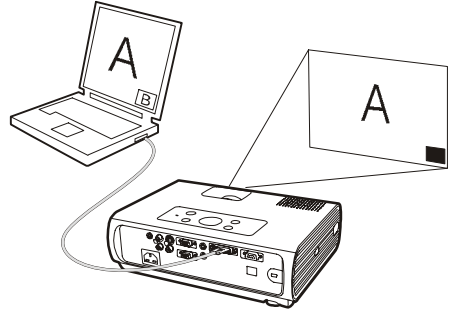

Solution

Press the **Source** button  
Activate laptop's external port

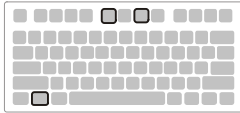

or restart  
laptop

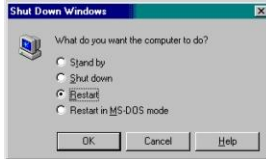

Turn off the internal LCD display on your  
laptop

Result

Computer image projected

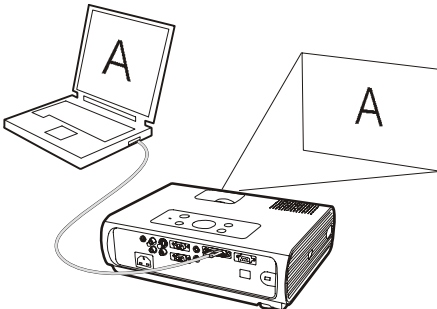

Embedded video plays correctly

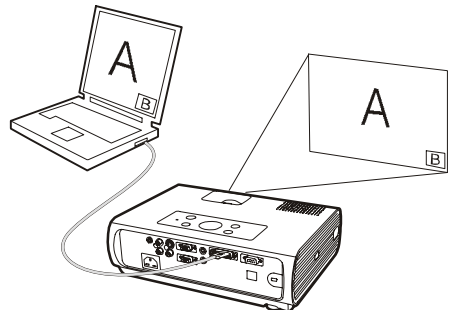

No computer image, just the words "signal out of range"

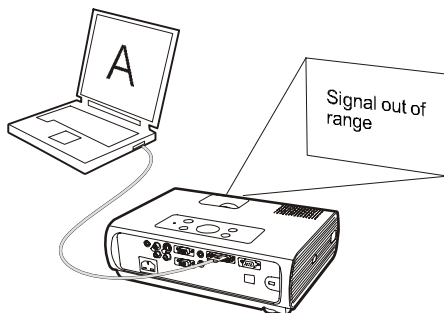
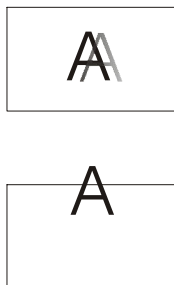
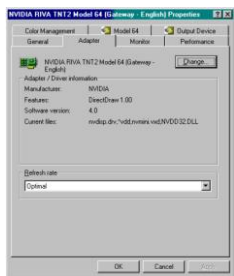

Image fuzzy or cropped



Adjust computer refresh rate in Control Panel>Display>Settings>Advanced>Adapter (location varies by operating system)



You may also need to set a different resolution on your computer, as shown in the following problem, "Image fuzzy or cropped"

Set your computer's display resolution to the native resolution of the projector (Start>Settings>ControlPanel>Display >Settings tab, select 1024x768)

For a laptop, disable laptop monitor or turn-on dual displaymode

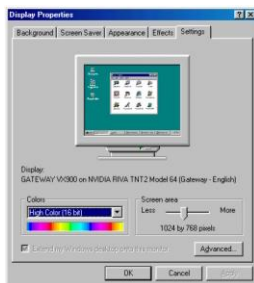

Computer image projected

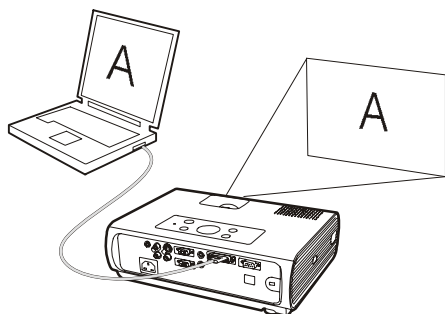

Image clear and not cropped



Image does not fit 16:9 screen



Image not square



Change aspect ratio to 16:9 on projector keypad or **Aspect Ratio** menu

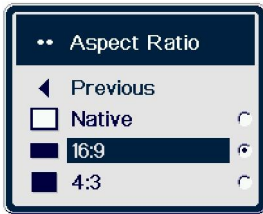

Adjust keystone on projector keypad or **Settings** menu

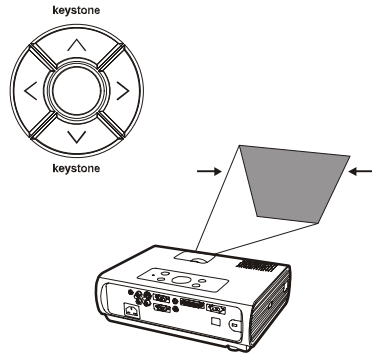

Correct image



Square image



Image upside down

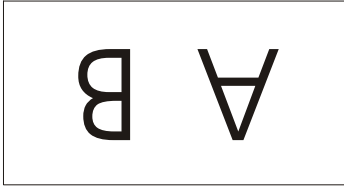

Image not sharp



Turn off Ceiling in **Settings** menu



Adjust the focus lens or **Sharpness** in the **Picture** menu

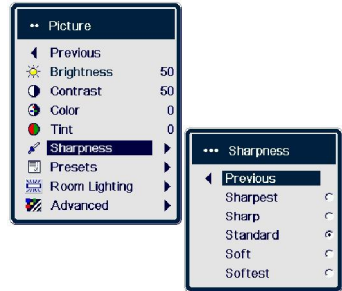

Correct image



Correct image



Projected colors don't match source

~~COLOR~~

Image reversed left to right

B A

Adjust color, tint, color temperature, brightness, contrast in the menus



Turn off Rear in Settings menu

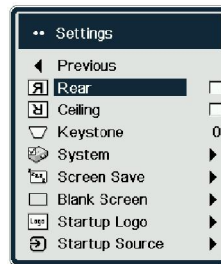

Correct image

COLOR

Correct image

A B

Lamp won't turn on, LED blinking red

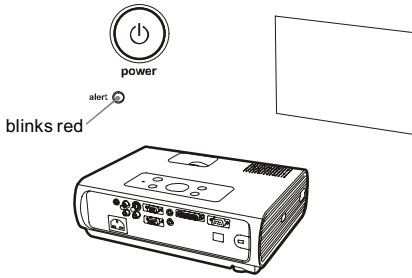

Lamp won't turn on, LED blinking red

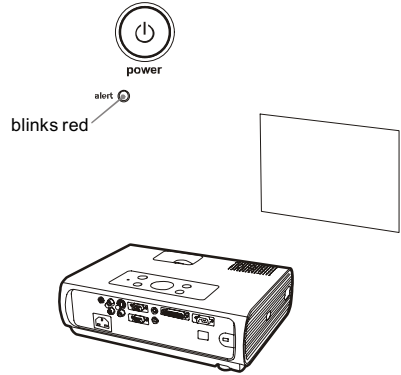

Lamp must be replaced  
(see page 32)

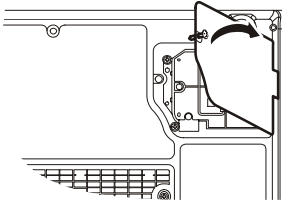

Make sure vents aren't blocked; allow projector to cool for one minute

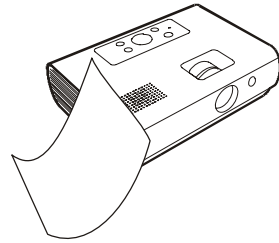

Lamp turns on

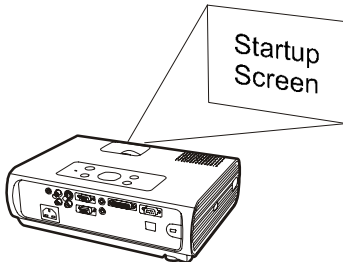

Unplug projector; wait one minute; plug in projector and turn it on; lamp lights

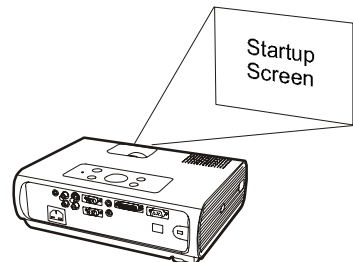
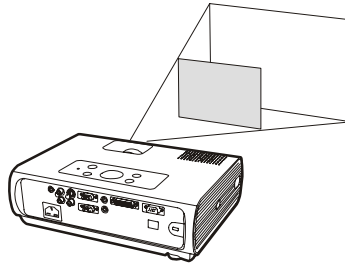
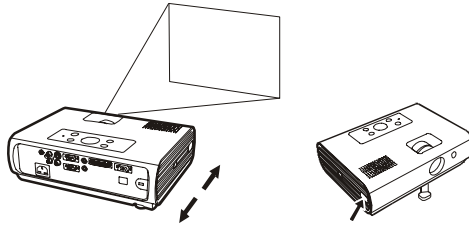

Image not centered on screen



Move projector, adjust zoom, adjust height



Adjust horizontal or vertical position in Picture> Advanced menu



Correct image

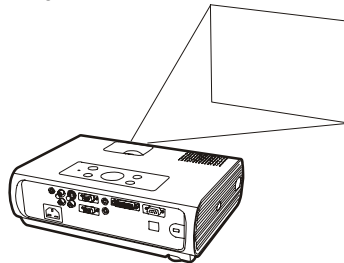

**Still having problems?**

If you need assistance, please contact your dealer.

# Using the keypad buttons

Most buttons are described in detail in other sections, but here is an overview of their functions:

**Power**- turns the projector on (*page 9*) and off (*page 14*).

**Menu**- opens the on-screen menus (*page 24*).

**Select**- confirms choices made in the menus (*page 24*).

**Aspect ratio**-Changes the projection output aspect ratio to <mode> for any input signal.

**Source**-Programs remote buttons to direct access to sources and selecting start up source.

**Keystone**- Changes Trapezoidal Distortion to fit screen when projector is tilted up or down relative to the optical axis (*page 10*).

**Vol**-adjusts sound (*page 27*).

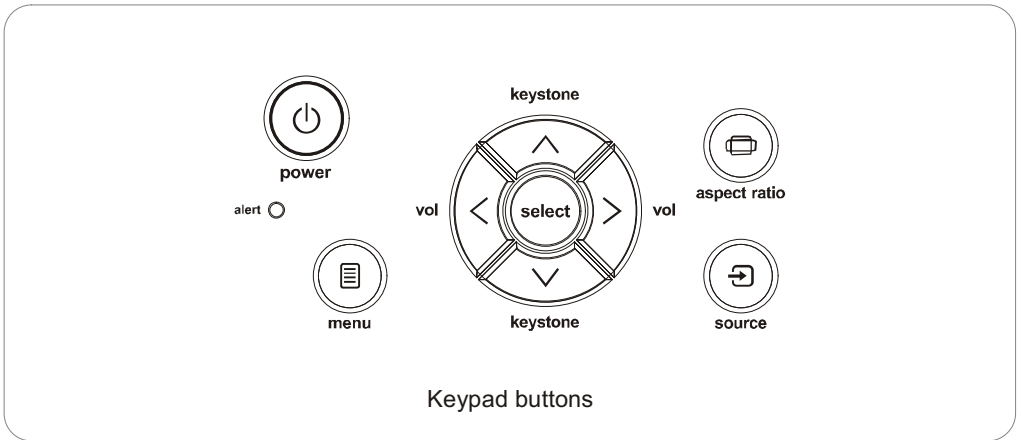

# Using the remote control

The remote uses two (2) provided AAA batteries. They are easily installed by sliding the cover off the remote's back, aligning the + and - ends of the batteries, sliding them into place, and then replacing the cover.

To operate, point the remote at the projection screen or at the projector (not at the computer). The range of optimum operation is about 30 feet (9m).

Use the Up/Down arrow buttons to adjust the image Keystone feature and use the Left/Right buttons to adjust the loudspeaker Volume.

Press the remote's **Menu** button to open the projector's menu system. Use the arrow buttons to navigate, and the **Select** button to select features and adjust values in the menus. See *page 24* for more info on the menus.

The remote also has a **Power** button to turn the projector on and off (see *page 14* for shutdown info), a **Source** button to switch between the different Video and Computer sources. Use the **Personal** button to invoke a user-definable action, such as freeze or zoom (see *page 25* to learn to program this button).

## Troubleshooting the remote

- Make sure the batteries are installed in the proper orientation and are not dead.
- Make sure you are pointing the remote at the projector, not the computer, and are within the remote range of 30 feet (9m).

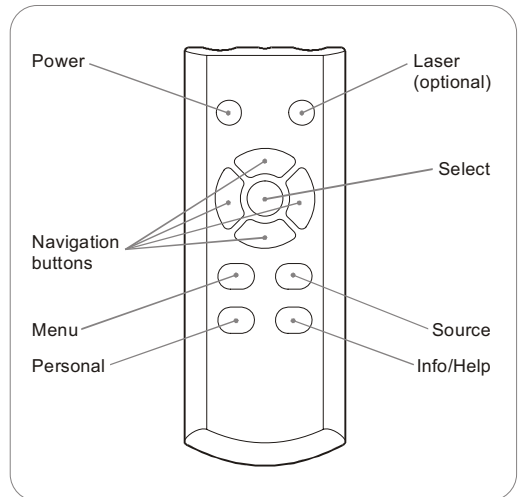

# Using the menus

To open the menus, press the **Menu** button on the keypad or remote. (The menu automatically close after 30 seconds if no buttons are pressed.) The Main menu appears. Use the arrow buttons to move up and down to highlight the desired submenu, then press the **Select** button.

To change a menu setting, highlight it, press **Select**, then use the up and down arrow buttons to adjust the value, select an option using radio buttons, or turn the feature on or off using check boxes. Press **Select** to confirm your changes. Use the arrows to navigate to another setting. When your adjustments are complete, navigate to Exit, then press **Select** to go to the previous menu; press the **Menu** button at any-time to close the menus.

Certain menu items may be grayed out until a particular source is connected. For example, Sharpness is only available for video sources and will be hidden when a computer source is active. Other menu items may be grayed out when they are not available. For example, Brightness is grayed out until an image is active.

Dots appear before the menu name. The number of dots indicate the menu's level, ranging from one (the Main menu) to four (the most nested menus).

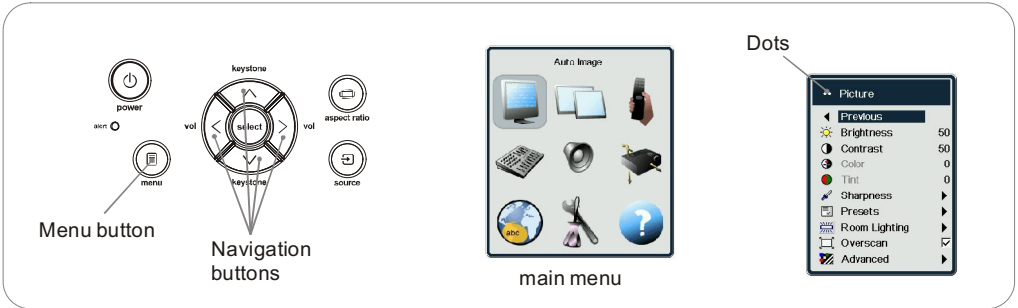

The main menu is grouped as seen in the figure above and listed below:

- The **Auto image** provides automatic image adjustments.
- The **Aspect Ratio** provides image width/height adjustments.
- The **Personal Key** menu assigns functions to the personal key on the remote.
- The **Picture** menu provides image adjustments
- The **Audio** menu provides audio adjustments
- The **Languages** menu provides set-up
- The **Settings** menu provides set-up
- The **Service** menu provides maintenance information
- The **Help** menu provides help and information



## Auto Image

**Auto Image** Causes the projector to automatically perfect the image of the the connected source. No menu, function only.



## Aspect Ratio

Aspect ratio is the ratio of the image width to image height.

TV screens are 4:3. HDTV and most DVDs 16:9. The default is 4:3, which displays the input resized up or down to fill the display area.

Aspect ratio Menu

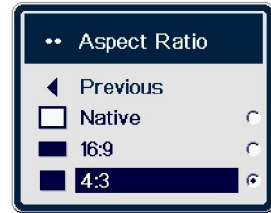

## Personal Key

**Personal Key** allows you to assign a function to the Personal Key button on the remote to quickly and easily use the selected function. Only one function can be enabled at a time. Highlight the function of your choice and press Select to assign it to the Personal Key button. The default is Freeze.

**Blank:** shows an empty screen.

**Freeze:** pauses the projected image.

**Zoom:** lets you magnify a part of the screen. To use the zoom effect, you must have the **Display Messages** (Settings > System) enabled. Press **Personal** to activate zoom, then use **Up** to zoom the image and **Down** to decrease the magnification. Press **Select** to activate pan and use the navigation buttons to pan the image, displaying different parts of it (only if the image is magnified).

**Aspect Ratio:** sets the ratio of the image width to image height.

**Mute:** turns off all sound.

**Auto Image:** causes computer source to be re acquired.

**Source:** cycles through the available sources.

Personal key Menu

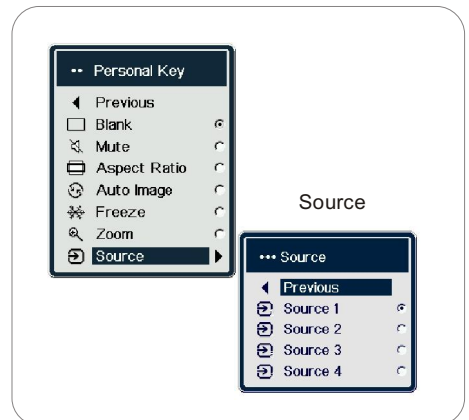
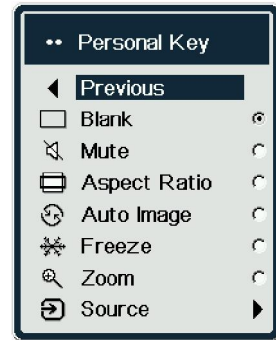



## Picture

To adjust the following six settings, highlight the setting, press **Select**, use the Left and Right buttons to adjust the values, then press select to confirm the changes.

**Brightness:** changes the intensity of the image.

**Contrast:** controls the degree of difference between the lightest and darkest parts of the picture and changes the amount of black and white in the image.

**Color:** (video and component sources only) adjusts a video image from black and white to fully saturated color.

**Tint:** (video sources only) adjusts the red-green color balance in the image.

**Sharpness:** (video sources only) changes the clarity of the edges of a video image. Select a sharpness setting.

**Presets:** The provided Presets optimize the projector for displaying computer presentations, photographs, and film images. To restore the factory default settings, choose Factory Reset in the **Service** menu.

**Room Lighting:** This features optimizes the projector for your room's lighting conditions. Select Dark if you are in a dark room, Light if in a bright room. Choosing Light maximizes the light output from the projector.

**Overscan:** (video sources only) removes noise around the video image.

## Picture Menu

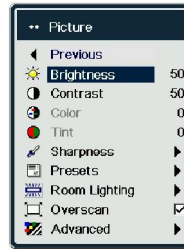
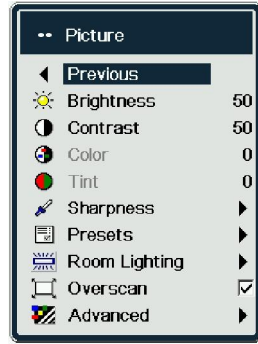

Brightness

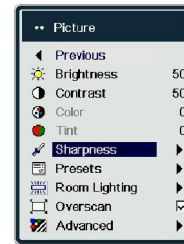

Sharpness

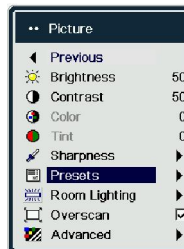

Presets

## Advanced: advanced settings

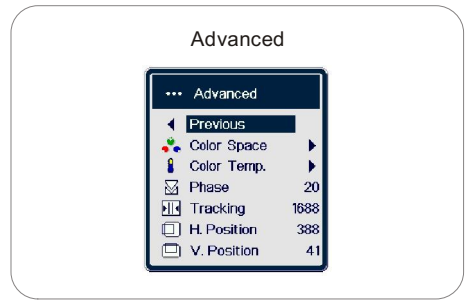

**ColorSpace:** This option applies to computer sources. It allows you to select a color space that has been specifically tuned for the video input. When Auto is selected, the projector automatically determines the standard. To choose a different setting, turn off Auto, then choose RGB for computer sources, choose either SMPTE240, REC709 or REC601 for component sources.

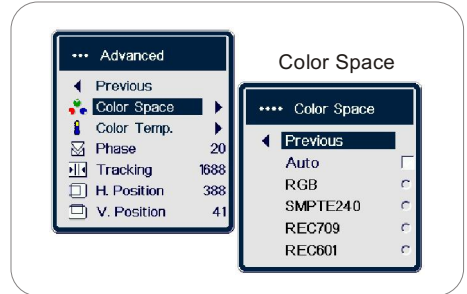

**Color Temperature:** changes the intensity of the colors.

The following 4 options are for computer and component sources only.

**Phase:** adjusts the horizontal phase of a computer source.

**Tracking:** adjusts the vertical scan of a computer source.

**H./V. Position:** adjusts the position of a computer source.

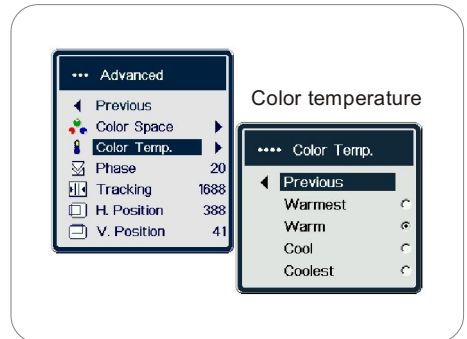

## Audio

**Audio** allows adjustments to the volume.

## Audio Menu





## Language

**Language:** allows you to select a language for the onscreen display of menus and messages.

Language Menu



## Settings

**Rear:** reverses the image so you can project from behind a translucent screen.

**Ceiling:** turns the image upside down for ceilingmounted projection.

**System:**

**Auto Power:** When Auto Power is checked, the projector automatically goes into the startup state after the projector is powered on. This allows control of ceiling mounted projectors with a wall power switch.

**Display Message:** displays status messages (such as Searching or Mute ) in the lower-left corner of the screen.

**Low Power:** toggles between on and off. Turn it on to lower the light output of the lamp. This also lowers the fan speed, making the projector quieter.

**Autosource:** When the **Autosource** feature is On, the projector automatically finds the active source.

**Power Save:** automatically turns the lamp off after no signals are detected for 20 minutes. After 15 additional minutes with no signal, the projector powers down. If an active signal is received before the projector powers down, the image will be displayed.

Settings Menu

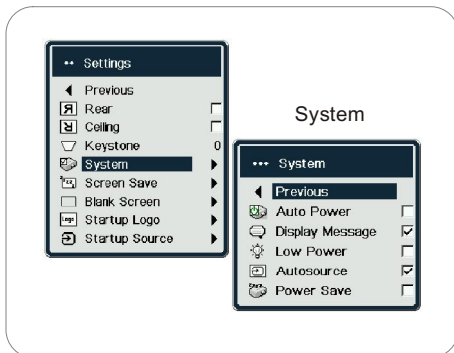

**Keystone:** adjusts the image vertically and makes a squarer image. You can also adjust vertical keystone from the keypad.

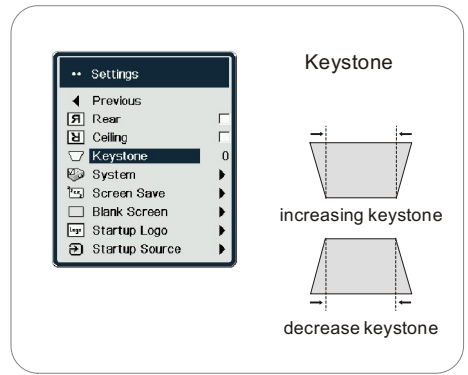

**Screen Save:** automatically blanks the screen with a black color after no signals are detected for a preset number of minutes. The image returns when an active source is detected or a remote or keypad button is pressed. Screen Save is disabled when Power Save is enabled.

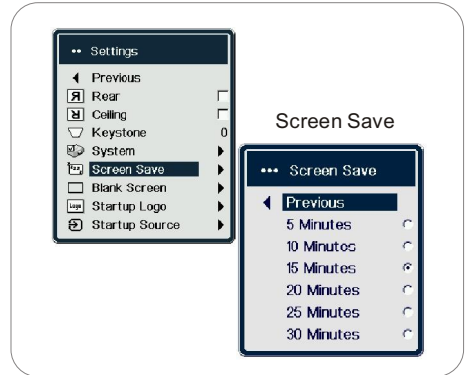

**Blank Screen:** When the Personal Key is assigned to the Blank Screen function, these options determines what color is displayed when you press the Personal Key.

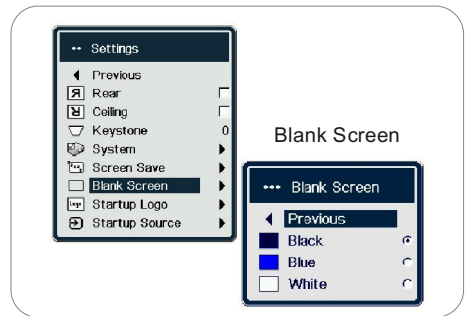

**Startup Logo:** allows you to display a blank Black, White, or Blue screen instead of the default screen at startup and when no source is detected.

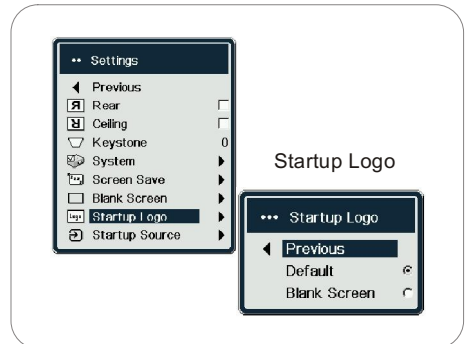

**Startup Source:** this determines which source the projector checks first for active video during power-up.

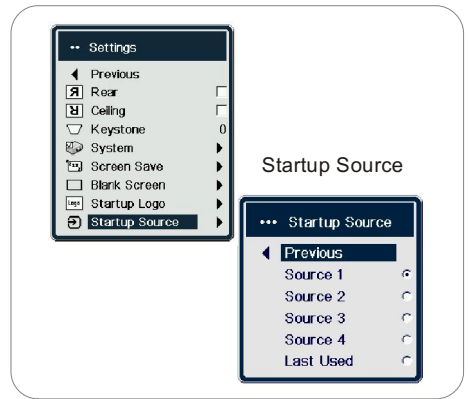

## Service

**Service:** to use these features, highlight them and press **Select**.

**Factory Reset:** restores all settings (except Lamp Hours and Network settings) to their default after displaying a confirmation dialog box.

**Reset Lamp:** resets the lamp hours counter in the About menu to zero. Do this only after changing the lamp. It displays a confirmation dialog box.

**Service Info:** provides information about the projector's software version and the active source.

**Service Code:** only used by authorized service personnel.

## Service Menu



 **Help**

**Auto Image:** Causes the projector to automatically perfect the image of the connected source.

**Source Info:** Displays the source info menu.

Help Menu



# Maintenance

## Cleaning the lens

- 1 Apply a non-abrasive camera lens cleaner to a soft, dry cloth. Avoid using an excessive amount of cleaner, and don't apply the cleaner directly to the lens. Abrasive cleaners, solvents or other harsh chemicals might scratch the lens.
- 2 Lightly wipe the cleaning cloth over the lens in a circular motion.

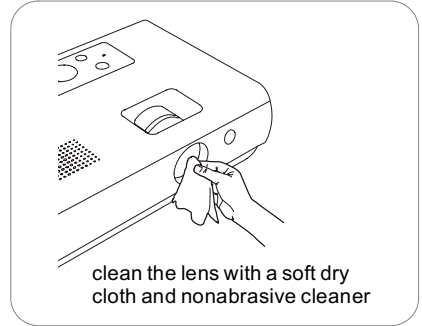

## Replacing the projection lamp

The lamp hour timer in the **Service** menu counts the number of hours the lamp has been in use. Fifty hours before the specified end of the lamps life, the message "Replace lamp" briefly appears on the screen at each startup. You can order new lamp modules from your dealer.

### Source info

Source Info	
Active Source	: Source 3
Resolution	: 1024 x 768
Vertical	: 85 Hz
Horizontal	: 68 kHz
Color Space	: RGB
LampHours Used	: 2 Hours

- 1 Turn off the projector and unplug the power cable.
- 2 Wait 60 minutes to allow the projector to cool thoroughly.
- 3 Turn the projector upside down, loosen the screw and remove the lamp door by grasping and lifting the screw.
- 4 Remove the screws on the lamp module.

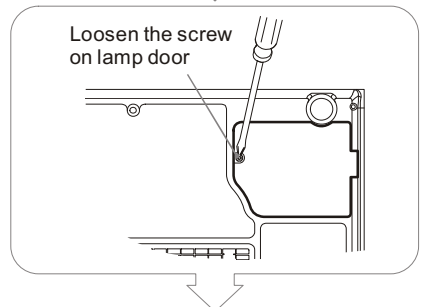
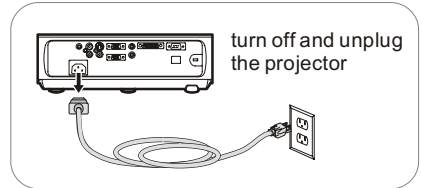

## WARNINGS:

- To avoid burns, allow the projector to cool for at least 60 minutes before you replace the lamp.
- Unplug the power cord before replacing the lamp.
- Do not drop the lamp module. The glass may shatter and cause injury.
- Do not touch the glass lamp screen. Please be sure you wear the plastic glove or fingertip when assembling the lamp. Fingerprints can obscure projection sharpness.
- Be extremely careful when removing the lamp housing. In the unlikely event that the lamp ruptures, small glass fragments may be generated. Please wear protection glass. The lamp module is designed to contain most of these fragments, but use caution when removing it. Before replacing the lamp, clean the lamp compartment and dispose of cleaning materials. Wash hands after lamp replacement. This product has a lamp which contains a very small amount of mercury. Dispose of it as required by local, state or federal ordinances and regulations. For more information see [www.chinaprojectors.com](http://www.chinaprojectors.com)

5 Carefully remove the lamp module by grasping and lifting the metal bail wire. Dispose of the lamp in an environmentally proper manner.

6 Install the new lamp module, making sure that it is properly seated.

7 Replace the screws on the lamp module.

8 Replace the lamp door and tighten the screw.

9 Plug in the power cable then press the **Power** button to turn the projector back on.

10 Reset the lamp hour timer.

## Resetting the lamp timer

If the lamp timer has reached the maximum number of hours for the projector lamp, the LED on the projector's keypad will show a lamp error (see "LED behavior and meaning" on page 16). To reset the lamp timer, navigate to the **Service** menu and select **Lamp Reset**.

remove the lamp door by grasping and lifting the screw

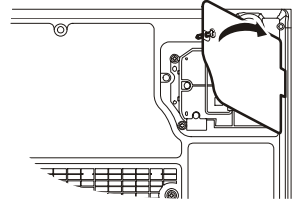

Loosen the screws on lamp module

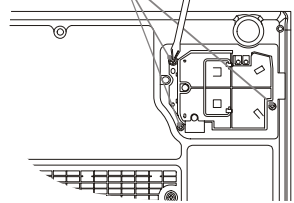

remove module using bail wire

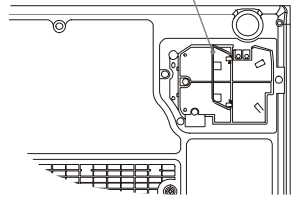

Reset lamp time in Service menu



## Cleaning the dust filters

The dust filters catch dust and other particles in the air. If the filters become clogged, the projector does not cool properly and may malfunction. In dirty or dusty environments, they should be cleaned after every 100 hours of use.

Failure to do so may result in premature lamp failure.

1 Turn off the projector and unplug the power cable.

2 Wait 60 minutes to allow the projector to cool thoroughly.

**WARNING:** To avoid burns, allow the projector to cool for at least 60 minutes before you clean or replace the dust filter.

3 Turn the projector upside down and loosen the screw on the dust filter door.

4 Remove the dust filter door by grasping and lifting the screw.

5 Clean the filter using a vacuum set on low power.

6 Replace the dust filter door.

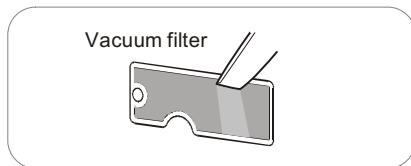
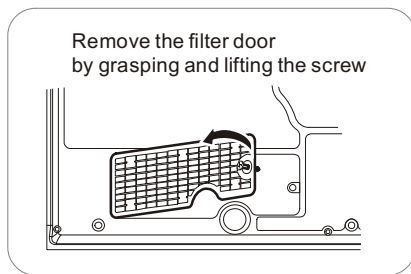
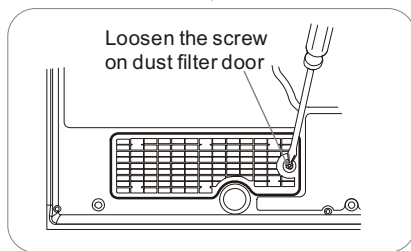
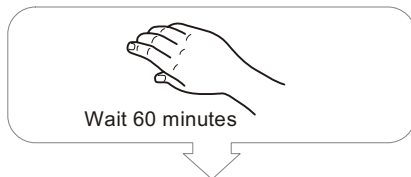
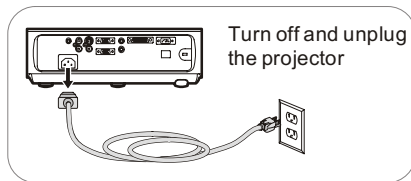

## Using the security lock

The projector has a security lock for use with a cable lock system. Seek your projector or computer store to purchase one, or check [www.kinsington.com](http://www.kinsington.com).

Refer to the information that came with the lock for instructions on how to use it.

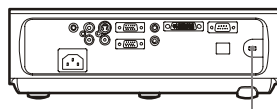

Security lock

# Appendix

## Accessories

### Standard Accessories (shipped with the projector)

Carry case	Computer Cable
Audio/Video Cable	Power Cable
Remote control	Batteries
Quick Startcard	User's Guide
Safety Card	

**NOTE:** Use only approved accessories.

## Blue LED Behavior and Meaning

**Table 1: Blue LED Behavior and Meaning**

Led color/behavior	Meaning
solid blue	The projector is power on, or the projector has been turned off and the fans have stopped.
blinking blue	The software is initializing when plug in the power cable, or the projector is powering down and the fans are running to cool the lamp.

## Red LED behavior and projector errors

If the projector is not functioning properly and the red LED is blinking, consult Table 2 to determine a possible cause. There are two second pauses between the blinking cycles. Visit our website for more details on the red LED error codes. See the inside back cover for contact information.

**Table 2: Red LED Behavior and Projector Errors**

Red LED Behavior	Explanation
One (1) blink	The lamp won't strike after five (5) attempts. Check the lamp and lamp door installations for loose connections.
Two (2) blinks	The lamp counter hours have exceeded lamp life hours. Replace the lamp and reset the lamp hours counter.
Three (3) blinks	The projector has shut down the lamp. Replace the lamp. Contact Technical Support for repair if replacing the lamp does not solve the problem.
Four (4) blinks	The fan has failed. Contact Technical Support for repair.
Five (5) blinks	The projector is overheating. Check for a blocked air vent. Contact Technical Support for repair if clearing the air vents does not solve the problem.

**Table 3:Image Size ( JAVES OLX-730 )**

Projection Distance		Image Diagonal size				Image Horizontal size			
		Wide		Tele		Wide		Tele	
Inch	m	Inch	m	Inch	m	Inch	m	Inch	m
57.1	1.45	40	1.0	33.3	0.8	32.0	0.8	26.6	0.7
87.0	2.21	60	1.5	50	1.3	48.0	1.2	40.0	1.0
116.9	2.97	80	2.0	67	1.7	64.0	1.6	53.6	1.4
146.5	3.72	100	2.5	83	2.1	80.0	2.0	66.4	1.7
220.9	5.61	150	3.8	125	3.2	120.0	3.0	100.0	2.5
295.7	7.51	200	5.1	167	4.2	160.0	4.1	133.6	3.4
444.5	11.29	300	7.6	250	6.4	240.0	6.1	200.0	5.1

**Table 4:Image Size ( JAVES OLX-625 )**

Projection Distance		Image Diagonal size				Image Horizontal size			
		Wide		Tele		Wide		Tele	
Inch	m	Inch	m	Inch	m	Inch	m	Inch	m
47.2	1.20	40	1.0	26.5	0.84	32.0	0.8	21.2	0.67
71.1	1.81	60	1.5	39.8	1.26	48.0	1.2	31.8	1.01
95.3	2.42	80	2.0	53.0	1.68	64.0	1.6	42.4	1.35
119.3	3.03	100	2.5	66.1	2.10	80.0	2.0	52.9	1.68
179.0	4.55	150	3.8	99.2	3.15	120.0	3.0	79.4	2.52
238.4	6.06	200	5.1	131.9	4.19	160.0	4.1	105.5	3.35
358.3	9.1	300	7.6	196.9	6.25	240.0	6.1	157.5	5.00

## RS-232 terminal specification

### Communication configuration

To control the projector using a PC, connect an RS-232 cable to the serial control connector on the projector and set your computer's serial port settings to match this communication configuration:

Setting:	Value:
Bits pr second	19200
Data bits	8
Parity	None
Stop bits	1
Flow control	None

### Command format

All commands consist of 3 alpha characters followed by a request, all enclosed in parentheses. The request can be a

- read requestor
- write request

A read request format is (xxx?) Where

- ( starts the command
- xxx denotes the command
- ? denotes the read request
- ) ends the command

A read command returns the range and the current settings, for example:

Function	Command	Response
Brightness	(BRT?)	(0-22, 10)
Lamp hours	(LMP?)	(0-9999, 421)

A write request format is (xxxNNNN) where

- ( starts the command
- xxx denotes the command
- NNN denotes the value to be written (leading zeros not necessary)
- ) ends the command

Some commands have ranges, while others are absolute. If a number greater than the maximum number range is received, it is automatically set to the maximum number for that function. If a command is received that is not understood, a " ? " is returned. With absolute settings, " 0 " is off, " 1 " - " 9999 " is on. The one exception is the Power command where " 0 " is off and " 1 " is on.

Function	Command	Response
Brightness	(BRT10)	Sets the brightness to 10
Power	(PWR0)	Turns power off
Power	(PWR1)	Turns power on
Power	(PWR999)	Unknown command

Command	Function	Range	Default value
AIM	Auto Image	0	n/a
APO	Auto Power Enable	0-1	0 (off)
ARZ	Aspect Ratio	0-2	0
		0=4:3	
		1=16:9	
		2= Native	
ASC	Auto Source Enable	0-1	1 (on)
BLK	Blank Screen	0-1	0 (off)
BRT	Brightness	0-100	50
BSC	Blank Screen Color	0-2	0
		0=Black	
		1=Blue	
		2=White	
CEL	Ceiling	0-1	0 (off)
CLR	Color	0-100	50
CON	Contrast	0-100	50
		0	
		1=RGB	
		2=RGB TV	
		3=YCBCR ITU601 ADC	
		4=YCBCR ITU601	
		5= YCBCR ITU709 ADC	
		6= YCBCR ITU709	
		7= YCBCR SMTE 240	
DHP	DHCP Enable	0-1	0 (off)
DKV	Vertical Keystone Correction	-25 to +25	0
DMG	Display UI Messages	0-1	1 (on)
DSC	Default Source	0-3	0

		0=Computer in (M1)	
		1=Computer in (VESA)	
		2=s-video	
		3=video	
DSU	Display Startup Logo	0-4	0
		0=Logo	
		1=Black	
		2=White	
		3=Blue	
EFK	PersonalKey Select	0-11	0
		0=Blank	
		1=Mute	
		2=Aspect Ratio	
		3=Auto Image	
		4=Freeze	
		5=Zoom	
		6=Source info	
		7=Mask	
		8=Source 1 (M1)	
		9=Source 2 (VESA)	
		10=Source 3 (s-video)	
		11=Source 4 (video)	
FRT	Filter Reset	0	0
FRZ	Freeze Display	0-1	0 (off)
FTI	Filter Time	n/a (read only)	n/a (read only)
HPS	Horizontal Position	0-600	n/a
IRE	IR Enable	0-1	0 (off)
LAN	Language	0-11	1
		0=German	
		1=English	
		2=Spanish	
		3=French	
		4=Italian	
		5=Japanese	
		6=Korean	
		7=Norwegian	
		8=Portuguese	

		9=Russian	
		10=Chinese simplified	
		11=Chinese Traditional	
LML	Lamp Lit	n/a (read only)	n/a (read only)
LMP	Lamp Time	n/a (read only)	n/a (read only)
LPE	Low Power Enable	0-1	0 (off)
LRT	Perform lamp hours reset	0	n/a
MTE	Mute	0-1	0 (off)
NAV	Menu Navigation	0-5	n/a
		0=up	
		1=down	
		2=left	
		3=right	
		4=select	
		5=menu (toggle on/off)	
OVS	Overscan	0-1	1 (on)
PNH	Pan Horizontal	Range is zoom dependant	n/a
PNV	Pan Vertical	Range is zoom dependant	n/a
PST	Presets	0-3	1
		0=Presentation	
		1=Photographic	
		2=Film	
PSV	Power Save Enable	0-1	0 (off)
PWR	Power	0-1	0 (off)
REA	Rear Project	0-1	0 (off)
ROL	Room Lightning	0-1	0
		0=Daylight	
		1=Dark	
RST	Factory Reset	0	n/a
SER	Serial Number	n/a (read only)	n/a (read only)
SHP	Sharpness	0-4	2
		0=sharpest	
		1=sharp	
		2=standard	
		3=soft	
		4=Softest	
SRC	Source Select	0-4	n/a

		0=Computer in (M1)	
		1=Computer in (VESA)	
		2=s-video	
		3=video	
SSV	Screen Save	0-5	2
		0=5 minutes	
		1=10 minutes	
		2=15 minutes	
		3=20 minutes	
		4=25 minutes	
		5=30 minutes	
SWR	Software Revision	n/a (read only)	n/a (read only)
TMP	Color Temperature	0-3	0
		0=warmest	
		1=warm	
		2=cool	
		3=coolest	
TNT	Tint	-90 to +90	0
VOL	Volume	0-100	50
VPS	Vertical Position	0-300	n/a
ZOM	Zoom	0-10	0 (off)